

RESTAURANT SPACE FOR LEASE

200 N. Church Street | Mishawaka, IN 46544



1st Floor High End Restaurant Space With Riverfront Location

Building:	32,891 SF
Space Available:	4,339 SF Retail/Restaurant
Land:	2.1 Acres
Zoning:	C-3 Commercial
Year Built:	1995; Remodeled 2023
Utilities:	Municipal
Parking:	On-site and off street
Lease Rate:	\$20.00 PSF NNN

[VIEW PROPERTY ONLINE](#)

Details:

Located in vibrant downtown Mishawaka, the former Mishawaka Police Headquarters has been transformed into a corporate headquarters! As much as 4,339 SF of riverfront space is available for a high end restaurant/cocktail lounge. Diners will enjoy sweeping views of the St. Joseph River from either the newly expanded outdoor seating area or from inside the space through the expansive windows. Abundant off street parking is provided and building signage is available. Join Sun King Brewing Co., Doc Pierce's, Jesus Latin Grill, Mishawaka Public House and many others that are capitalizing on the commercial and residential boom centered around Beutter Park and downtown Mishawaka!

The space enjoys easy access from 2 sides of the building, has ample available parking and a wall of windows flood the space with natural light. Great opportunity to be in the heart of rapidly evolving downtown Mishawaka!



NAI Cressy

P 574.271.4060 | CRESSY.COM | CONNECT WITH US! [in](#) [X](#) [f](#) [YouTube](#)
200 N. Church St., Suite 200, Mishawaka, IN 46544

Cressy Commercial Real Estate is a Minority Business Enterprise (MBE) as well as certified by the National Native American Supplier Council (NNASC).



Information furnished regarding property for sale, rental or financing is from sources deemed reliable. But no warranty or representation is made as to the accuracy thereof and same is submitted subject to errors, omissions, change of price, rental or other conditions, prior sale, leased, financing or withdrawal without notice. No liability of any kind is to be imposed on the broker herein. NAI Cressy is the Global Brokerage Division of Cressy Commercial Real Estate.

Tim Mehall
Vice President, Retail Services
D 574.485.1516
tmehall@cressy.com

John Mester
Senior Broker, Retail / Investments
D 574.485.1501
jmester@cressy.com

SITE PLAN

RESTAURANT SPACE FOR LEASE

200 N. Church Street | Mishawaka, IN 46544

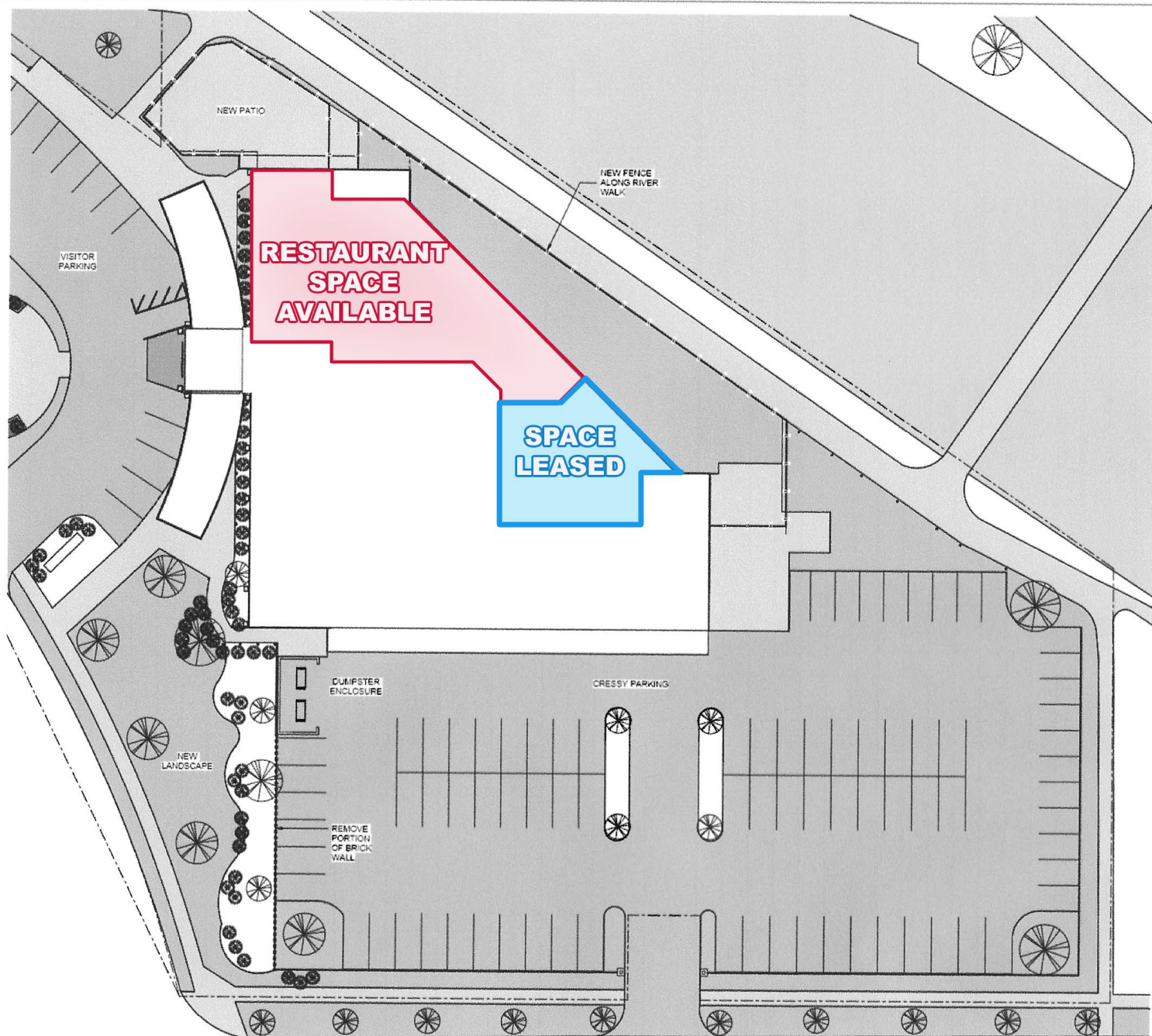

FLOOR PLAN

RESTAURANT SPACE FOR LEASE

200 N. Church Street | Mishawaka, IN 46544

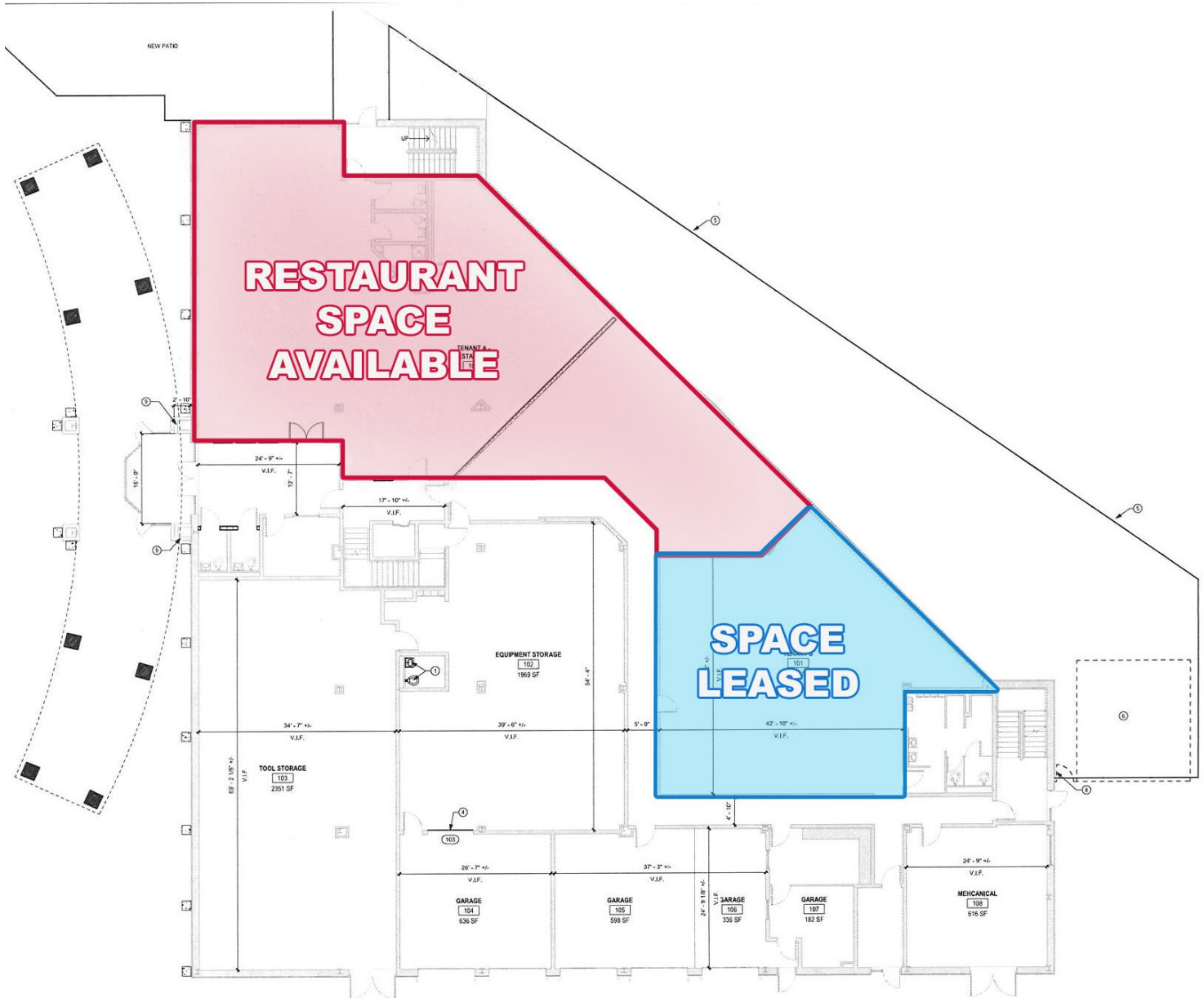

RENDERING & PHOTOS

RESTAURANT SPACE FOR LEASE

200 N. Church Street | Mishawaka, IN 46544

Rendering



LOCATION OVERVIEW

RESTAURANT SPACE FOR LEASE

200 N. Church Street | Mishawaka, IN 46544

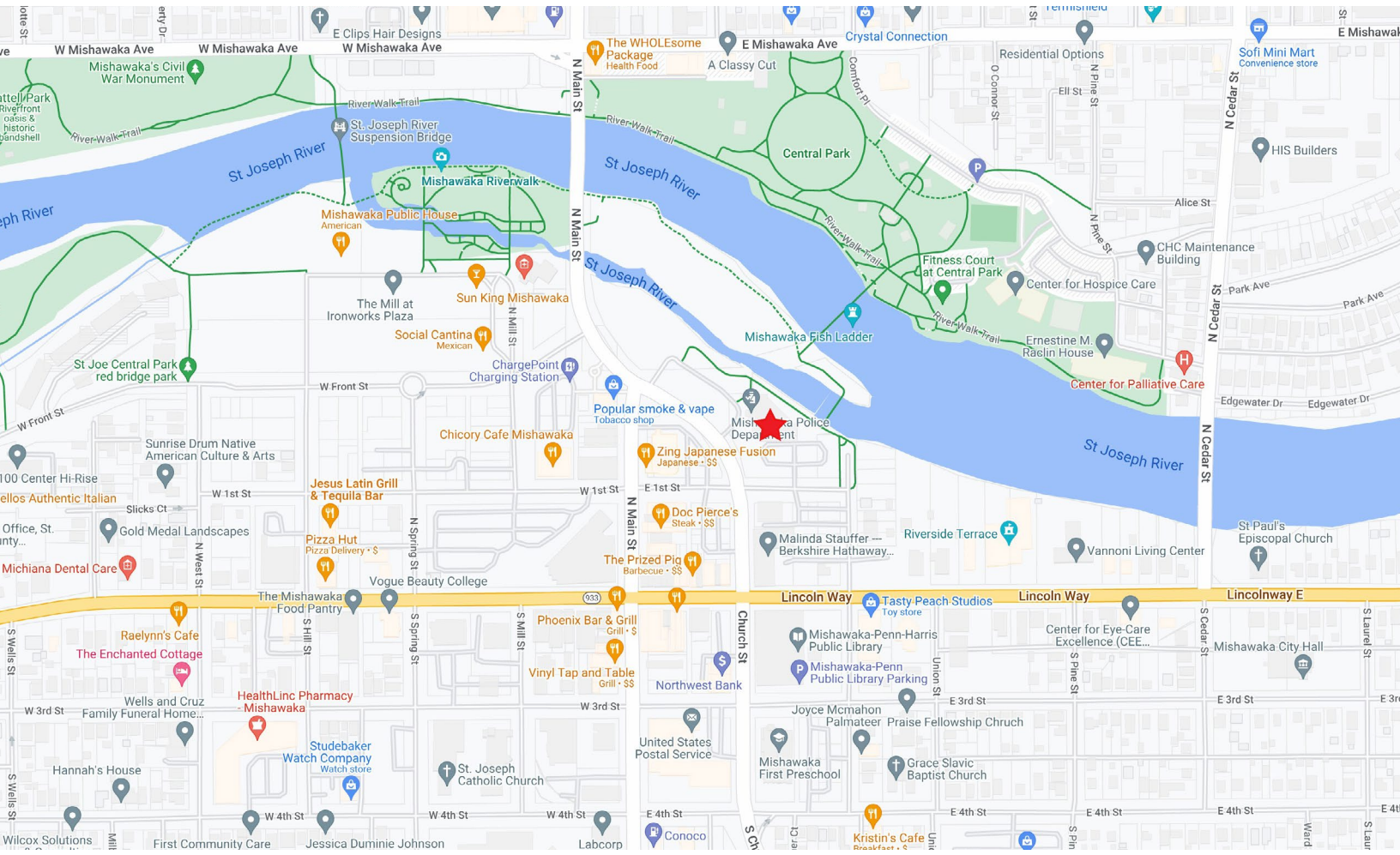

- Be in the heart of the rapidly developing downtown Mishawaka business district. Hundreds of new high end multi family units have been recently developed with more coming in 2024.
- Join Sun King Brewery, Jesus Latin Grill & Tequila Bar, Mishawaka Public House, Social Cantina and Doc Pierce's as well as many others. Adjacent to the recently developed Beutter Park and along the St. Joseph River, this is an exciting opportunity to be part of a live, work, play environment that is difficult to come by today.
- Riverfront views, outdoor seating along the river and a new corporate presence all combine for an ideal opportunity
- Traffic Counts: 16,547 on N. Church Street, 22,750 on Main Street, 11,729 on Lincolnway.



NAI Cressy is the Global Brokerage Division of Cressy Commercial Real Estate.

Tim Mehall
Vice President, Retail Services
D 574.485.1516
tmehall@cressy.com

John Mester
Senior Broker, Retail / Investments
D 574.485.1501
jmester@cressy.com

2025 DEMOGRAPHICS

RESTAURANT SPACE FOR LEASE

200 N. Church Street | Mishawaka, IN 46544

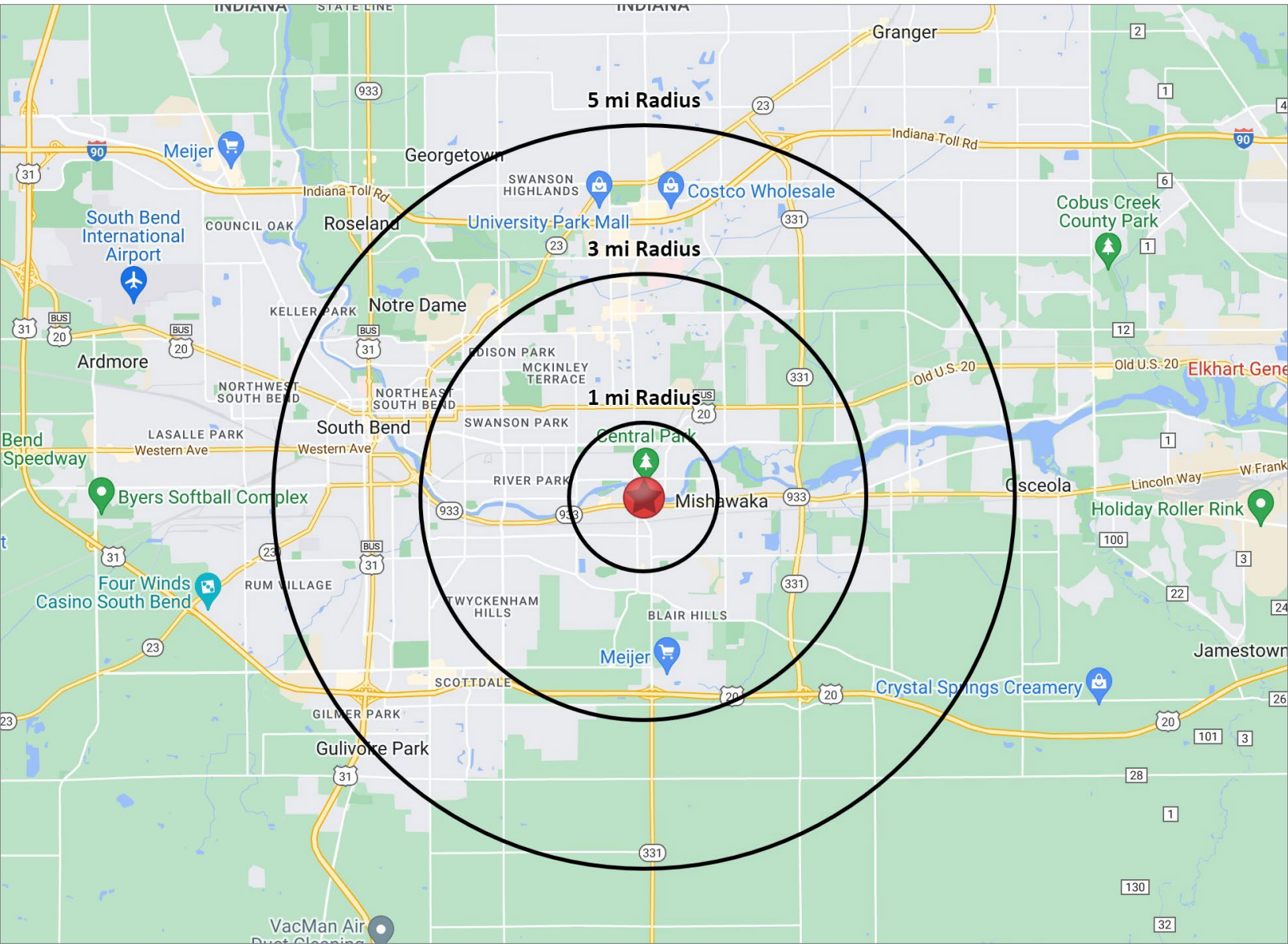

POPULATION

1 MILE	14,394
3 MILE	75,063
5 MILE	152,746



NUMBER OF HOUSEHOLDS

1 MILE	3,692
3 MILE	18,539
5 MILE	35,212



AVERAGE HOUSEHOLD INCOME

1 MILE	\$71,816
3 MILE	\$80,718
5 MILE	\$86,889



MEDIAN HOME VALUE

1 MILE	\$139,699
3 MILE	\$171,861
5 MILE	\$192,789



is the Global Brokerage Division
of Cressy Commercial Real Estate.

Tim Mehall
Vice President, Retail Services
D 574.485.1516
tmehall@cressy.com

John Mester
Senior Broker, Retail / Investments
D 574.485.1501
jmester@cressy.com